

Unofficial Property Record Card - Holyoke, MA

General Property Data

Parcel ID **006-07-001**
Prior Parcel ID **--**
Property Owner **D'ACTION ENTERPRISES, LLP**
Mailing Address **232 LYMAN ST**
City **HOLYOKE**
Mailing State **MA** Zip **01040**
Parcel Zoning **BG**

Account Number
Property Location **228 236 LYMAN ST**
Property Use **STORE**
Most Recent Sale Date **12/23/1997**
Legal Reference **10110-350**
Grantor **GUIEL WILLIAM V**
Sale Price **250,000**
Land Area **0.278 acres**

Current Property Assessment

Card 1 Value Building Value **279,600** Xtra Features Value **10,100** Land Value **27,200** Total Value **316,900**

Building Description

Building Style **COMM BLOCK**
of Living Units **7**
Year Built **1986**
Building Grade **AVG. (+)**
Building Condition **Good**
Finished Area (SF) **7208**
Number Rooms **0**
of 3/4 Baths **0**

Foundation Type **SLAB**
Frame Type **STEEL**
Roof Structure **FLAT**
Roof Cover **MEMBRANE**
Siding **CONC BLOCK**
Interior Walls **DRYWALL**
of Bedrooms **0**
of 1/2 Baths **5**

Flooring Type **CARPET**
Basement Floor **N/A**
Heating Type **FORCED H/A**
Heating Fuel **GAS**
Air Conditioning **100%**
of Bsmt Garages **0**
of Full Baths **0**
of Other Fixtures **7**

Legal Description

Narrative Description of Property

This property contains 0.278 acres of land mainly classified as STORE with a(n) COMM BLOCK style building, built about 1986, having CONC BLOCK exterior and MEMBRANE roof cover, with 7 unit(s), 0 room(s), 0 bedroom(s), 0 bath(s), 5 half bath(s).

Property Images

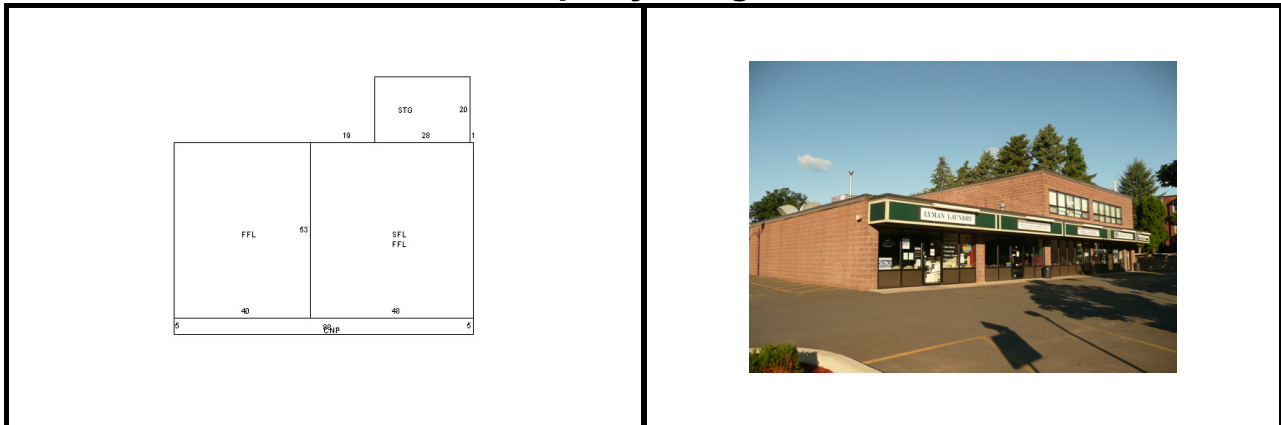

Disclaimer: This information is believed to be correct but is subject to change and is not warranted.